

GOBOSERVICE

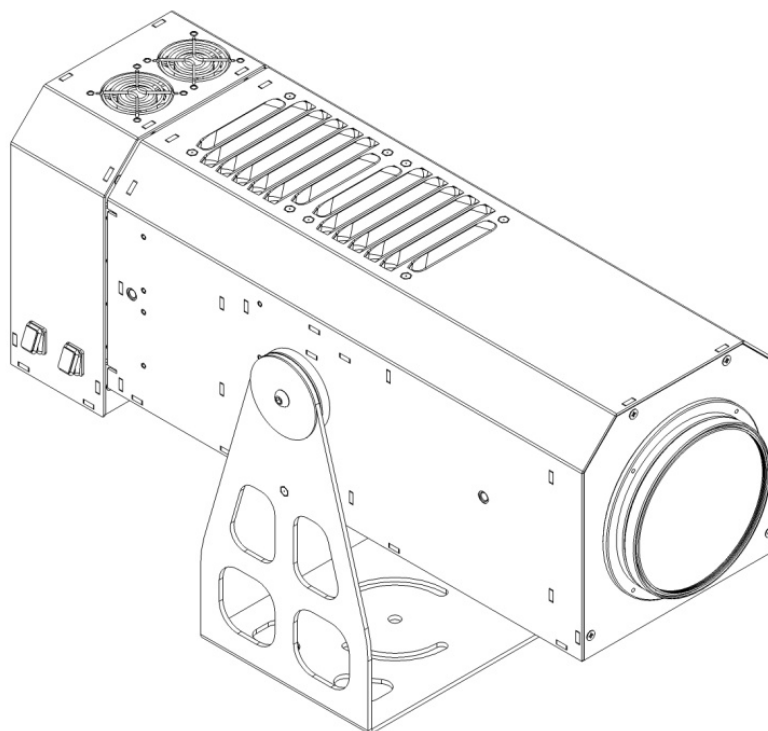

MANUALE DI ISTRUZIONI
USER GUIDE
NOTICE D'UTILISATION

GOLUX Plus

Goboservice by SunlandOptics SRL

Via Vecchia Provinciale 167 – Archi – 89121 Reggio Calabria (RC)

+39 0965 813264

Via 2 Giugno 19/10 – Bonate Sotto – 24040 (BG)

+39 035 0176860

www.goboservice.com

info@goboservice.com



GOBOSERVICE

GOLUX Plus

USER GUIDE

Thank you for choosing our projector! We inform you that this product was designed and realized to guarantee you the best performance and to satisfy your expectations and requirements.

Please read this manual carefully before using the product.

The manual is an important part of this equipment. It must be stored with care for a period of 10 (ten) years, in an easily accessible place.

Following the instructions of this user guide is essential in order to guarantee correct and safe installation, use and maintenance of the product.

Goboservice by Sunland Optics SRL accepts no liability for damages caused to the projector or to other property or persons deriving from installation, use and maintenance which was not carried out in accordance with the manual.

Goboservice by Sunland Optics SRL reserves the right to change the information in this manual at any time and without notice.

INDEX

1. SAFETY INFORMATION	Errore. Il segnalibro non è definito.
1.1. INSTALLATION	Errore. Il segnalibro non è definito.
1.2. MINIMUM DISTANCE FROM ILLUMINATED OBJECTS	Errore. Il segnalibro non è definito.
1.3. MINIMUM DISTANCE FROM FLAMMABLE MATERIALS	Errore. Il segnalibro non è definito.
1.4. MAXIMUM TEMPERATURE OF THE ENVIRONMENT	Errore. Il segnalibro non è definito.
1.5. PROTECTION DEGREE	Errore. Il segnalibro non è definito.
1.6. PROTECTION AGAINST INDIRECT CONTACTS	Errore. Il segnalibro non è definito.
1.7. CONNECTION TO THE POWER SUPPLY	Errore. Il segnalibro non è definito.
1.8. EXTERNAL SURFACE TEMPERATURE	Errore. Il segnalibro non è definito.
1.9. MAINTENANCE	7
1.10. LAMP	7
1.11. DAMAGED SCREEN REPLACEMENT	Errore. Il segnalibro non è definito.
1.12. VISION HAZARDS	Errore. Il segnalibro non è definito.
1.13. PHOTOBIOLOGICAL SAFETY	Errore. Il segnalibro non è definito.
1.14. RESIDUAL RISKS	8
2. PACKAGE CONTENTS	Errore. Il segnalibro non è definito.
3. PROJECTOR INSTALLATION	Errore. Il segnalibro non è definito.
3.1. FRONT PANEL	Errore. Il segnalibro non è definito.
3.2. BACK PANEL	Errore. Il segnalibro non è definito.
3.3. LAMP MOUNTING/REPLACEMENT	Errore. Il segnalibro non è definito.
3.4. GOBO MOUNTING INSTRUCTIONS	Errore. Il segnalibro non è definito.
3.5. ACCESSORIES INSTALLATION AND REMOVAL	Errore. Il segnalibro non è definito.
3.6. DYNAMIC EFFECT AND BEAM SHAPER	Errore. Il segnalibro non è definito.
3.7. GOBO CHANGER KIT	Errore. Il segnalibro non è definito.
3.8. ACCESSORIES POWER SUPPLY	Errore. Il segnalibro non è definito.
3.9. RAIN COVER MOUNTING	Errore. Il segnalibro non è definito.
4. USE OF PROJECTOR	Errore. Il segnalibro non è definito.
4.1. CONNECTION TO THE POWER SUPPLY	Errore. Il segnalibro non è definito.
4.2. PROJECTOR ORIENTATION AND MOUNTING	Errore. Il segnalibro non è definito.
4.3. PROJECTED IMAGE SIZING AND FOCUSING	Errore. Il segnalibro non è definito.
4.4. CONTROL PANEL	Errore. Il segnalibro non è definito.
5. TECHNICAL DATA	Errore. Il segnalibro non è definito.
6. POSSIBLE PROBLEM CAUSES AND SOLUTIONS	21

7. DIRECTIVES	21
8. DISPOSAL.....	Errore. Il segnalibro non è definito.
9. WARRANTY	Errore. Il segnalibro non è definito.
10. MAINTENANCE HISTORY	Errore. Il segnalibro non è definito.

1. SAFETY INFORMATION

Please, read the following safety instructions carefully before starting to use the device. The product described in this manual is a lighting fixture used for a light beam projection. It is usually used for projecting fascinating, large-scale, decorative effects, logos and images with a high level of surface brightness. The projector must be only used for the purpose it was designed for. It is suitable for indoor and outdoor illumination, any other use is not approved by the manufacturer and for this reason, the manufacturer disclaims any liability for damages resulting from improper or incorrect use. This unit should be disposed of in accordance with your country's regulations.

1.1. INSTALLATION

Please, make sure that the surface on which you are going to install the projector is suitable for it. In some cases, you might have to use dowels or screws or other anchorages adapted to the surfaces the projector has to be mounted on. Before positioning the projector, make sure that all fixings are in good condition and that anchorage is stable. The safety cable, properly hooked to the appliance and attached to the support structure, must be installed in such a way that, in the event of failure of the primary support system, it has the lowest possible impact on the appliance. When the safety cable must eventually be replaced, this must be done with another cable with the same characteristics.

1.2. MINIMUM DISTANCE FROM ILLUMINATED OBJECTS

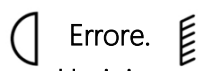

The projector must be placed at least 5,0 meters away from the projection surface.

1.3. MINIMUM DISTANCE FROM FLAMMABLE MATERIALS

Flammable materials must be placed at least 6 metres away from the projector lens and 1 metre away from any other surface of the projector.

1.4. MAXIMUM TEMPERATURE OF THE ENVIRONMENT

t_a Errore. L'origine
riferimento non è
stata trovata.

Install the projector in a place with good ventilation. Please, do not use it in closed or semi-closed environments due to a possible temperature increase, which will reduce the lifespan of the projector. For safe projector functioning the temperature must not exceed 40°C.

1.5. PROTECTION DEGREE

Direct exposure to rain, snow, hail or liquids in general can damage the product. The projector should be kept away from damp surfaces.

ATTENTION: when the appliance is connected to electricity, avoid contact with water. To protect the appliance from rain, use the Rain Cover accessory.

1.6. PROTECTION AGAINST INDIRECT CONTACTS



It is mandatory to connect the projector to mains power supply with efficient earthing (Class I appliance according to EN 60598-1 standard). It is also recommended to protect projector power supply lines from indirect contacts and / or wire to ground through the use of appropriately sized differential switches.

1.7. CONNECTION TO THE POWER SUPPLY

Connection to the power supply must be carried out by a qualified technician. Make sure that the frequency and voltage of the network correspond to the frequency and voltage indicated on the rating plate.

The absorbed power is also indicated on the same plate. Ensure that power line can withstand the power absorbed by the projector and if so, check the maximum number of devices that can be connected to the power line to avoid overloads.

If the external flexible cable of this appliance is damaged, it must only be replaced by the manufacturer, by authorised after-sales service, or equally qualified personnel. If the projector is used in a residential environment, in some cases it may be necessary to take specific measures to avoid electromagnetic radio frequency interference.

1.8. EXTERNAL SURFACE TEMPERATURE

t_cErrore. L'origine
riferimento non è stata
trovata.

In the thermally steady state, the maximum temperature which can be reached on the external surface of the device is 60°C.

1.9. MAINTENANCE

Before starting any maintenance works or cleaning the projector, turn the power off at the mains supply. After turning the projector off, wait at least 15 minutes to let the internal parts cool down to avoid burns.

Do not use the projector without lenses; if lenses are visibly damaged, they must be replaced with original spare parts.

1.10. LAMP



Carefully read the "operating instructions" provided by the lamp manufacturer. You will find the information about the supplied lamp in the PACKAGE CONTENTS section of this manual. Immediately replace the lamp if it is damaged or deformed by heat.

1.11. DAMAGED SCREEN REPLACEMENT



Replace damaged display screen immediately.

1.12. VISUAL HAZARDS

Do not look at the light beam directly or through any optical instruments.

1.13. PHOTOBIOLOGICAL SAFETY

ATTENTION: This product might emit dangerous optical radiation. Do not look at the light beam with optical tools or other instruments that could cause convergence of light. To prevent photobiological hazards, please, place the projector in such a way that the minimum distance from the projector lens to the human eye is at least 2 meters.

1.14. RESIDUAL RISKS

The product design respects all regulations and precautions, however, residual risks, related to certain structural aspects of the product usage, remain. Please, do not disassemble the device. Maintenance should be carried out by a qualified technician. Please, do not tamper with the ballast, it is sealed for safety reasons and should remain so. Once unsealed, the product is no longer under warranty. Put the unit in a visible place, so that it does not hinder the movement of people. Do not put the device in places, where it can fall or where it might represent a hazard to people or animals. Keep out of reach of children when the device is operating or still connected to the mains power. If the package is damaged, please do not turn the projector on. Keep out of reach of individuals, who can be affected by the correct or wrong use of the product. If the device is not connected to the power supply, it is not dangerous neither for people nor animals, even if exposed to the rain. The projector works at a low voltage which makes it no more dangerous than a typical household appliance; therefore, it requires appropriate behaviour. The device is made of high-quality materials and designed in compliance with all the safety criteria to prevent hazards and minimize risks.

2. PACKAGE CONTENTS

Upon receipt, please, make sure that the projector hasn't been damaged during transportation and all its parts are in perfect condition; if not, please contact the manufacturer immediately.

The package should be disposed of in accordance with your country's waste disposal rules.

- N°1 Projector GOLUX Plus
- N°1 Pen-drive that contains User Guide and Warranty
- N°1 1000W Lamp (Philips MSR GOLD 1000 MINIFASTFIT 1CT/4).

3. PROJECTOR INSTALLATION

3.1. FRONT PANEL

Image 1 shows the front view of the projector.

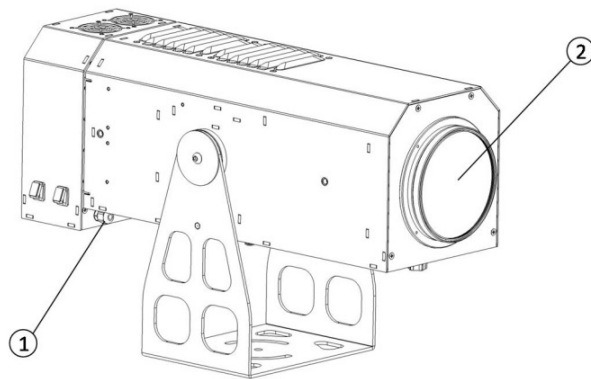

Image 1

Element 1 is a cable gland connector from which the power cable comes out. Element 2 is a photographic quality lens.

3.2. BACK PANEL

Image 2 shows the back panel of the projector.

Element 1 is a projector power switch.

Element 2 is an internal accessory (gobo rotator, dynamic effect, gobo changer) switch.

Element 3 is a control panel of the main functions of the projector.

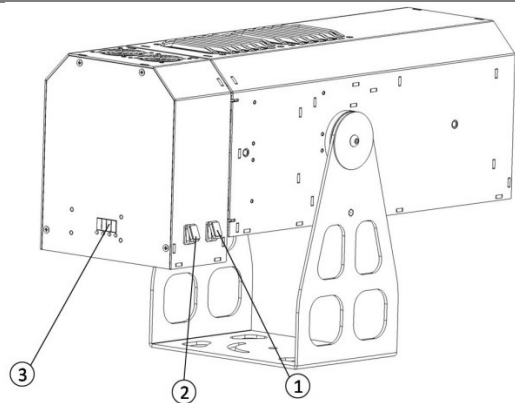

Image 2

3.3. LAMP MOUNTING/REPLACEMENT

To mount or replace the lamp, follow the steps below:

1. Open the power supply body as shown in Image 3.
2. Loosen, but do not remove the two anchor screws of the lamp holder cover as shown in Image 4, then rotate the cover clockwise.
3. Using a cloth, turn the lamp anticlockwise, as shown in Image 5.
4. Remove the lamp (see Image 6) and mount the new one by inserting it in the special slot. Turn it clockwise until you hear a click.

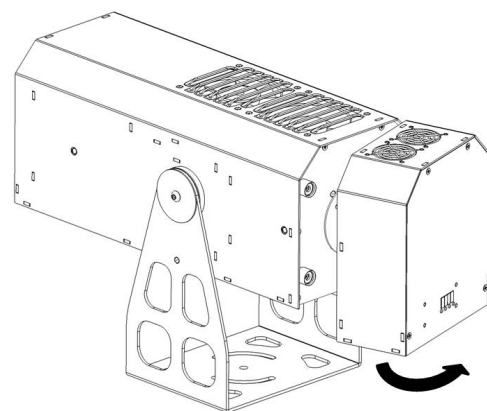

Image 3

5. Put the lamp holder cover back in place and tighten the two previously loosened screws.

6. Close the power supply body.

ATTENTION: Before turning the projector on, make sure that all its parts are in place and the power supply body is closed correctly (emitted light may be dangerous). Disconnect the projector from the electricity before replacing the lamp.

Allow at least 15 minutes after the use for the internal components of the projector to cool down to carry out any maintenance work.

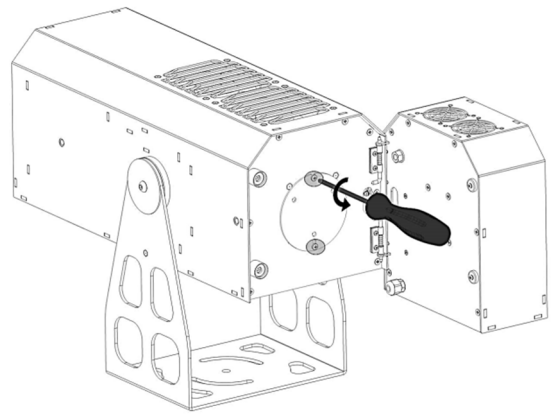

Image 4

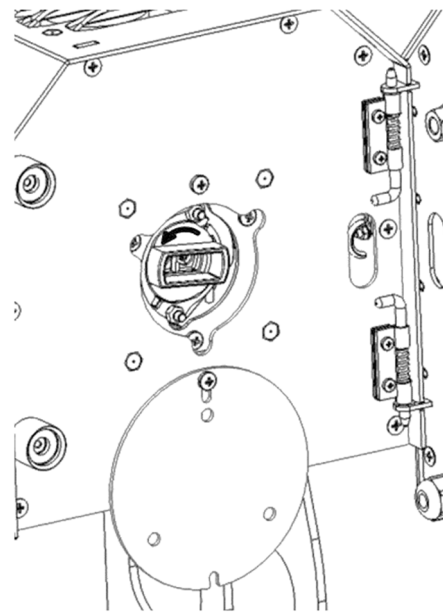

Image 5

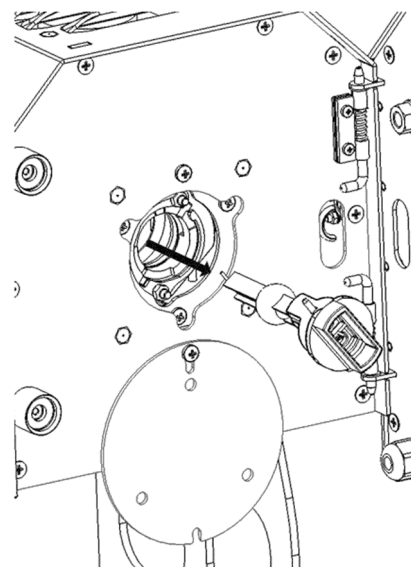

Image 6

3.4. GOBO MOUNTING INSTRUCTIONS

A gobo has two main parameters that allow its correct mounting inside the projector; these parameters (Image 7) are:

- OD (Outer Diameter) is the physical gobo diameter;
- ID (Inner Diameter) is a diameter of the circle with the actual image.

GOLUX Plus gobos must have OD = 37,5mm and ID = 25mm.

For gobos with special graphic features, please contact Goboservice customer service at info@goboservice.com to get advice on the best configuration.



Image 7

During gobo installation/replacement make sure that the REFLECTING SIDE ALWAYS FACES THE LAMP; hence THE MATT (BLACK/GREY) SIDE MUST FACE THE LENS (Image 8).

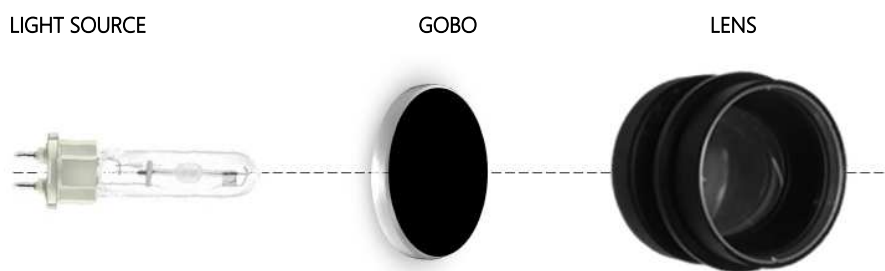

Image 8

Once you are ready to insert the gobo, open the projector by unscrewing the appropriate fixings (Image 9) and withdraw the gobo holder accessory. Remove the spring clip and a previously installed gobo (if any), insert your desired gobo inside the special hole, making sure it fits well (Image 10), then fix the gobo with the clip, insert the gobo holder and close the compartment again by pressing the fixing points (Image 11).

ATTENTION: to replace/mount a gobo, we recommend removing the gobo holder accessory. Please, refer to chapter 3.5 ACCESSORIES INSTALLATION AND REMOVAL.

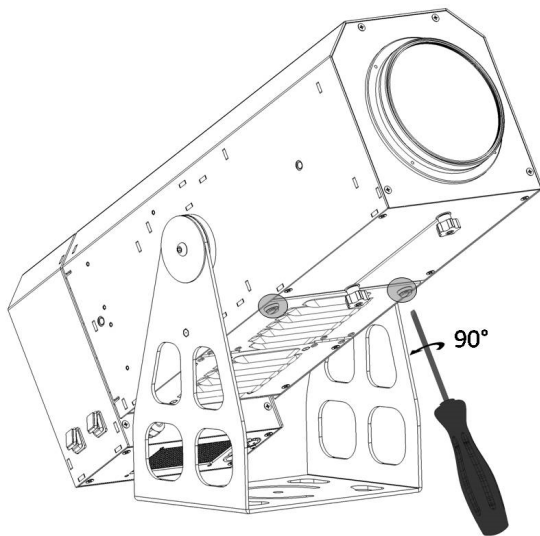

Image 9

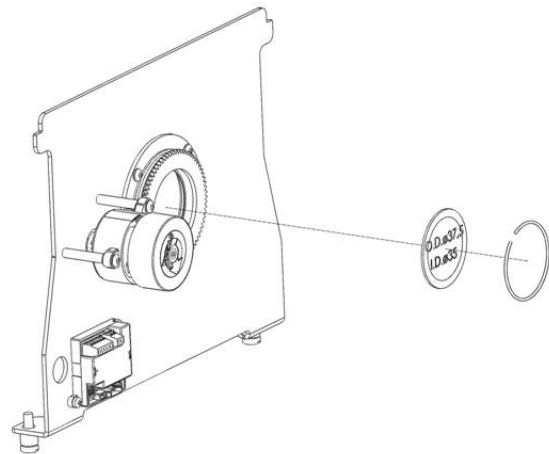

Image 10

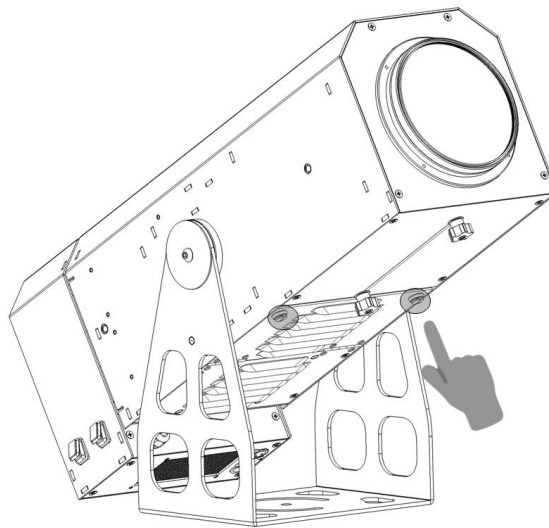

Image 11

Please, pay attention when mounting a gobo. Wear gloves if possible to avoid staining, leaving fingerprints or scratching the gobo surface. The scratches, with the heat generated inside the projector, can cause gobo cracking.

The gobo mounting/replacement must be carried out when the projector is switched off and disconnected from the mains supply. If the gobo must be replaced after using the projector, allow at least 15 minutes for all internal components of the projector to cool down.

3.5. ACCESSORIES INSTALLATION AND REMOVAL

This projector can be used with various accessories, indicated in chapter 5 TECHNICAL DATA - OPTIONAL ACCESSORIES.

To install or uninstall an accessory, open the lower door as explained in chapter 3.4 GOBO MOUNTING INSTRUCTIONS (Image 9).

Removal

- unscrew the captive screws of the accessory (Image 12)
- release the accessory from the respective fixings by pulling it as shown in Image 13
- carefully pull the accessory out, avoiding contact with the fixings of other mounted accessories and other internal parts of the projector.

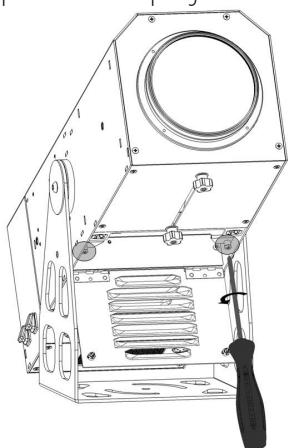

Image 12

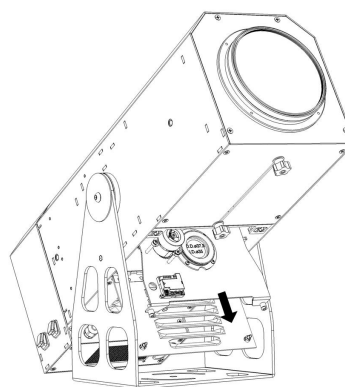

Image 13

Installation

- find the correct holes and fixings of the accessory that has to be installed (Image 14)
- insert the accessory until it locks in
- tighten the captive screws
- if appropriate, connect the accessory to the 12V power point (Image 14)
- close the lower door, as explained in chapter 3.4 GOBO MOUNTING INSTRUCTIONS (Image 9).

Rotating Gobo-holder	1A
Dynamic Effect	2C
Gobo Changer Kit	2C
Beam Shaper	1B

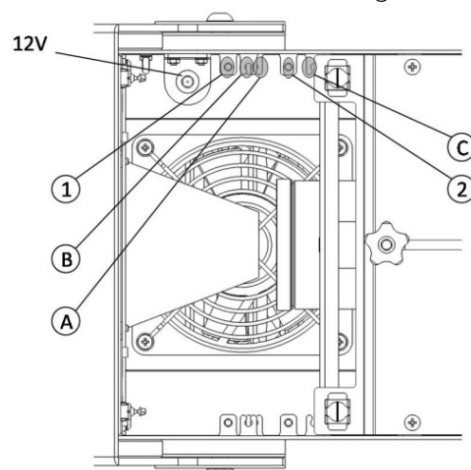

Image 14

ATTENTION: The installation/replacement of the accessories must be carried out when the projector is switched off and disconnected from the power line. If you need to install/uninstall the accessories after use, please wait for at least 15 minutes for the internal components to cool down.

3.6. DYNAMIC EFFECT AND BEAM SHAPER

The Dynamic Effect accessory can be installed instead of the rotating Gobo-holder.

The accessory consists of 2 major components (Image 15):

1. A mechanical part of the accessory which spins;
2. A standard or custom effect wheel (snowfall, shooting stars, musical notes, etc.)

Please, refer to chapters 3.4 GOBO MOUNTING INSTRUCTIONS and 3.5 ACCESSORIES INSTALLATION AND REMOVAL to open/close the compartment.

To mount component 2:

1. Place component 2 on component 1 so that the metal washer of the wheel sits on the pin and is attached to the flat magnetic part of the pulley.
2. Close the projector.

The Beam Shaper accessory can be combined with the Dynamic Effect (Image 16). Achieve your desired projection size and shape by adjusting the four metal fins at the bottom of the accessory.

ATTENTION: When carrying out these operations, please, use a glove and pay particular attention to handling the effect wheel, as it is fragile.

Installation/replacement of component 2 must be carried out when the projector is switched off and disconnected from the power line. If you need to install/uninstall the accessories after use, please allow at least 15 minutes for the internal parts to cool down.

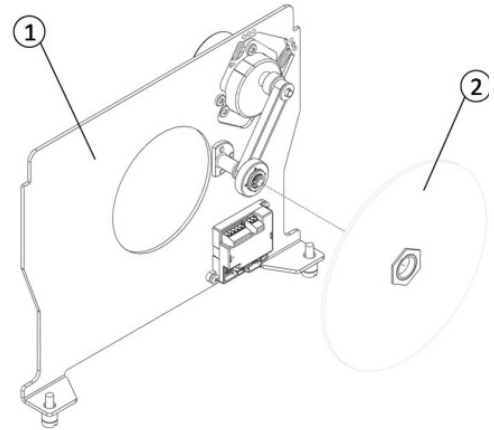

Image 15

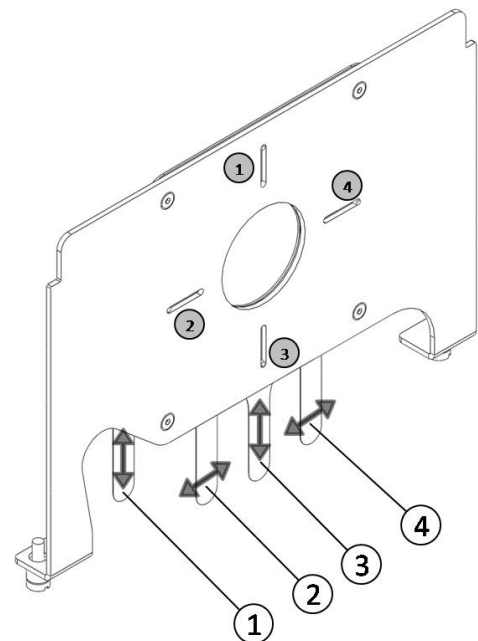

Image 16

3.7. GOBO CHANGER KIT

The Gobo Changer Kit accessory can be installed instead of the rotating Gobo-holder.

The accessory consists of 2 major components (Image 17):

1. Component 1 is a mechanical part of the accessory which spins;
2. Component 2 is a wheel with 5 gobo slots.

Please, refer to chapters 3.4 GOBO MOUNTING INSTRUCTIONS and 3.5 ACCESSORIES INSTALLATION AND REMOVAL to open/close the projector and install component 1.

Let's see how to mount component 2:

1. Place component 2 on component 1, making sure that the slot of the wheel sits on the pin and is attached to the flat magnetic part of the pulley.
2. Close the projector.

ATTENTION: When carrying out these operations, please, use a glove and pay particular attention to handling the gobos, as they are fragile.

Installation/replacement of component 2 must be carried out when the projector is switched off and disconnected from the power line. If you need to install/uninstall the accessories after use, please allow at least 15 minutes for the internal parts to cool down.

The Gobo Changer Kit operates via Goboservice App or DMX. Please refer to the dedicated page of the manual.

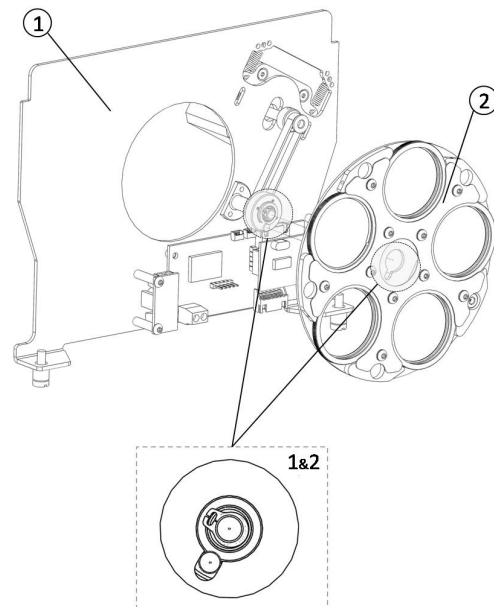

Image 17

3.8. ACCESSORIES POWER SUPPLY

Should it be necessary to use an internal accessory, other than standard gobo holder, that requires a connection to the power, please make sure that the plug of that accessory is connected to the power point inside the projector, as shown in Image 18.

The power supply can be turned on/off via the switch on the rear panel of the projector (Image 2).

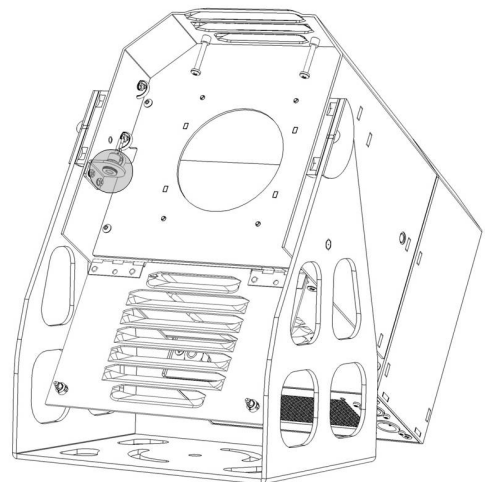

Image 18

3.9. RAIN COVER MOUNTING

To use the projector in adverse environmental conditions, please install the Rain Cover accessory (Image 19).

The two support points inside it help to position it (A).

Once the accessory is placed correctly, secure it with the 4 screws (B).

ATTENTION: The Rain Cover does not protect the bottom of the projector, so do not install the projector upside down.

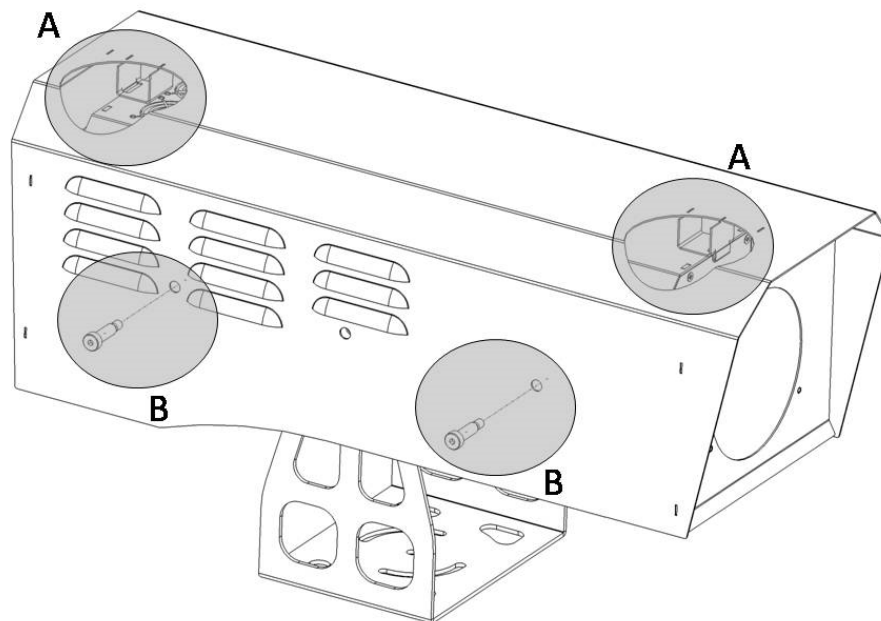

Image 19

4. USE OF PROJECTOR

4.1. CONNECTION TO THE POWER SUPPLY

When connecting the device to the power, please follow the normal safety and operation procedures valid for any appliance that works at low voltage.

ATTENTION: Please, make sure that the power supply voltage complies with the product characteristics and that the power supply line has an efficient grounding system and a differential switch with the following features:

- Rated current $I_n = 20A$
- Differential current $I_{\Delta n} = 0.03A$

When the projector is connected to electricity, avoid contact with water or any other liquids.

4.2. PROJECTOR ORIENTATION AND MOUNTING

Orientation

The GOLUX Plus model can be tilted both upwards and downwards by loosening the bolts (Image 20) on both sides, positioning the projector in the desired direction and retightening the fixings.

ATTENTION: Please do not position the projector downwards in such a way that it comes into contact with the support surface (Image 21).

Always refer to the indications concerning the minimum distance from the illuminated objects (5 m).

Mounting

If necessary, please use the "Extendable Stand" accessory.

To mount the GOLUX Plus to the "Extendable Stand" or any other surface, always use at least 2 M10 type screws.

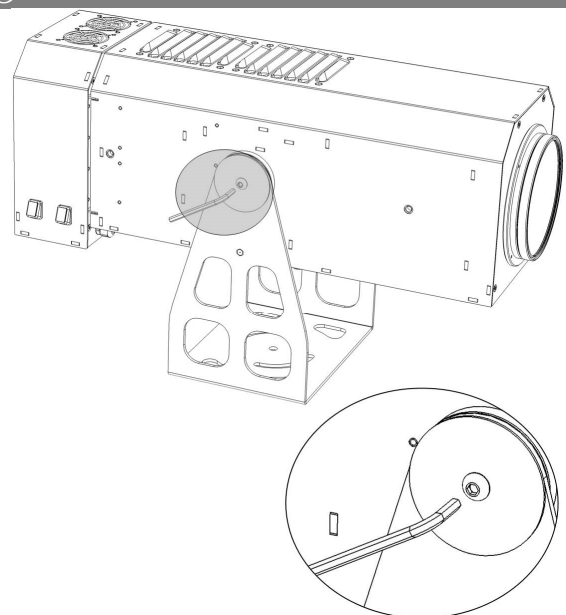

Image 20

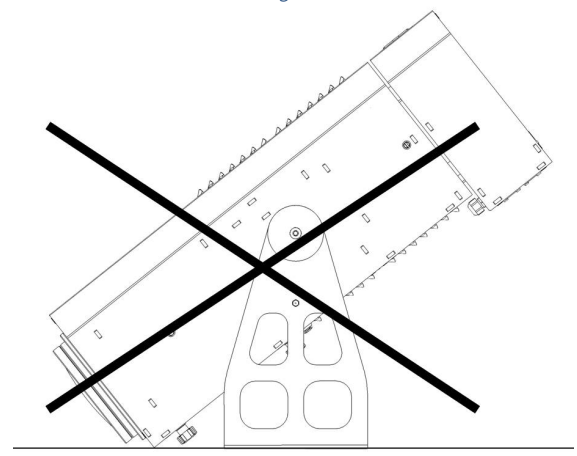

Image 21

4.3. PROJECTED IMAGE SIZING AND FOCUSING

To focus the projected image, please loosen the little knobs of the lens and move it back and forth until the image is crisp (Image 22).

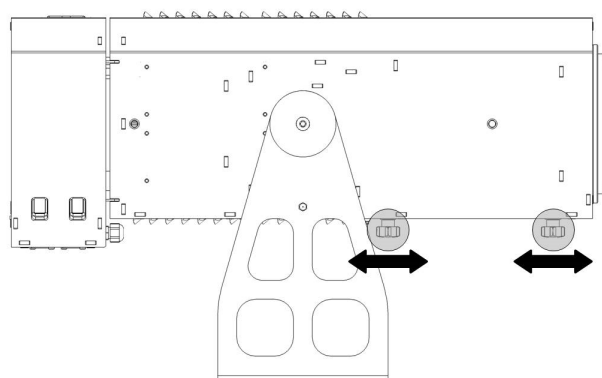

Image 22

4.4. CONTROL PANEL

The GOLUX Plus control panel allows you to access various functions, including the main ones:

- Ballast operating time
- Duration and number of times the lamp has been turned on
- Voltage, current and instantaneous power of the lamp
- temperature
- DMX

MENU e BACK	ENTER	DOWN	UP

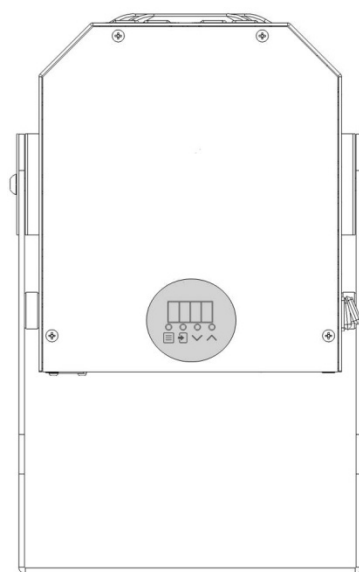

Image 23

TIME life time control		
H.tot Total hours ballast		
M.tot Total minutes ballast		
H.LAM Total hours lamp		
M.LAM Total minutes lamp		
Acc.L Number of times the lamp has been turned on		
CL.L.V. Reset (life and Number of times the lamp has been turned on)	Y.CLr Confirm reset	Press C.MEM* for 1 second to confirm
Mon.b. –Ballast control		
P.out Nominal Power	xxxx Instant Power	r.xxx Change of Nominal Power Value

V.out Nominal tension	xxxx Instant Tension	
I. out Nominal Current	xxxx Instant Current	
t.PFC PFC Temperature	xxxx PFC instant temperature	M.P.xx PFC max temperature
t.dCd DC/DC temperature	xxxx DC/DC Instant temperature	M.d.xx DC/DC max temperature
Id.dr Remote ID display and change	Selezione N° remote ID	Press ENTER to confirm
Ad.dM Change DMX address	Select DMX address	Press ENTER to confirm
VERs		
xx.xx Software version		

The ballast can also work with the DMX signal.

Control it through these 3 channels:

- CH2: DIMMER

000-004 No Effect

005-255 Dimmer from maximum power to minimum

- CH3: STROBE

000-004 No Effect

005-255 Strobe from 6.5Hz to 35Hz

- CH4: FADE

000-004 No Effect

005-255 Fade time from 13s to 120ms

The DMX address is changed in the Ad.dM → A.xxx menu

5. TECHNICAL DATA

DIMENSIONS & WEIGHT

Length	64,2 cm
Width	25,0 cm
Height	38,8 cm
Weight	15 kg

HOUSING

Body	Aluminum
Finish	Opaque
Colour	Black

POWER

Voltage	220/240 Vac - 50/60 Hz
Power	1100 W

LAMP

Type	Philips MSR Gold 1000 MiniFastFit 1CT/
Power	1000 W
Luminous flux	82.000 lm
Colour temperature	6.000 °K
Life	900 h

PHOTOMETRICS

Luminous output	25.800 lm
Gobo size	OD: Errore. L'origine riferimento non è stata trovata. ID: Errore. L'origine riferimento non è stata trovata.
Available lenses	Zoom 9°-53°

OPTIONAL ACCESSORIES

Rotating Gobo-holder	[OD: Errore. L'origine riferimento non è stata trovata. – ID: Errore. L'origine riferimento non è stata trovata.]
Dynamic Effect	
Gobo Changer Kit	5 Gobos [OD: Errore. L'origine riferimento non è stata trovata. – ID: Errore. L'origine riferimento non è stata trovata.]
Beam-shaper	
Extendable Stand	
Pole Bracket	Basic - Pro
Rain cover	

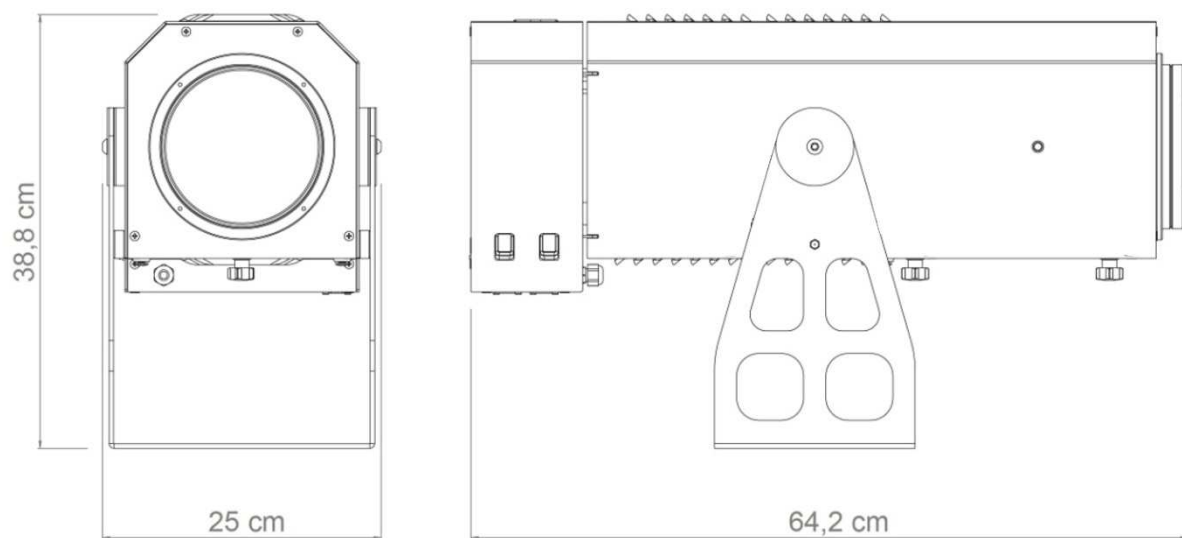

Image 24

6. POSSIBLE PROBLEM CAUSES AND SOLUTIONS

PROBLEMS	POSSIBLE CAUSES	SOLUTIONS
The projector does not turn on The projector turns on but does not emit any light	No power supply COB LED low or damaged	Ensure connection to the power supply Contact the customer service for overhauling
Reduced brightness	Accidental displacement of the reflector, COB Led low, dirtiness of the optical elements	Thorough cleaning of the optical elements or contact customer service
When the projector is connected, thermal magnetic circuit breaker is bypassed	The thermal magnetic breaker is undersized in comparison with the projector characteristics	Bypass or replace the thermal magnetic breaker
Defective projection	Gobo or optical elements might be broken; dust or dirt deposits	Technical consultation, gobo cleaning

7. DIRECTIVES



The products listed in this manual comply with the European Community Directives to which they are subject:

- 2014/35 / EU LVD - Safety of electrical equipment supplied at low voltage;
- 2014/30 / EU EMC - Electromagnetic Compatibility;
- 2011/65 / EU ROHS - Restriction of the use of certain hazardous substances;
- 2009/125 / EC ERP – Eco Design requirements for Energy-related Products.

The device meets all the requirements of the applicable directives which are proved by CE marking on the product and the declaration of conformity.

8. DISPOSAL



The device must be disposed of in compliance with the applicable laws related to lighting products. In any case, it should not be put among normal waste or litter the environment as, **even if prosecuted**, it is a serious threat to animals and people and a source of long term pollution. The product must not be treated as simple urban waste and must be disposed of properly in accordance with the differentiated waste disposal regulations.

9. WARRANTY

The product is covered by a warranty. For more information, please refer to the warranty terms, specified in Annex 1.

In case of malfunction during the warranty period, the product will be repaired or replaced, based on the manufacturer's evaluation.

To claim product replacement or servicing under the warranty, please provide us with:

- Date of purchase (invoice date);
- A detailed description of the problem.

The unit was sent to you in perfect condition. Any damage, caused by not following the User Guide, will void the warranty, and the manufacturer assumes no legal responsibility.

Any repair/servicing should be carried out by the manufacturer. The manufacturer denies any responsibility for the unauthorized dismantling of a projector (even partial), which will void the warranty.

Consumables are not covered by the guarantee.

The manufacturer reserves the right to modify the contents of this User Guide at any time and without prior notice.

10. MAINTENANCE HISTORY

Projector Model: _____

Date of purchase: _____

Serial Number: _____

First turned
on date: _____

[illegible]

ACCESSORIES PROVIDED

This image shows a blank sheet of white paper with horizontal ruling lines. The lines are evenly spaced and extend across the width of the page. There are no margins, text, or other markings on the paper.

NOTES

This image shows a full page of blank handwriting practice paper. It features approximately 28 evenly spaced horizontal black lines across the entire page, providing a guide for letter height and placement. The background is plain white, and there are no margins, text, or other markings present.

DATI ETICHETTA
LABEL DATA
DONNÉES D'ÉTIQUETAGE

GOLUX *Plus*

Main Power: 110-240V/50-60Hz/1000W

GOBOSERVICE by Sunland Optics

Via 2 Giugno 19/10

24040 Bonate Sotto (BG)

www.goboservice.com

MADE IN ITALY

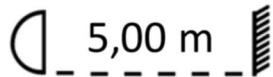

$T_a 40^{\circ}\text{C}$

$T_c 60^{\circ}\text{C}$



Goboservice by SunlandOptics SRL

Via Vecchia Provinciale 167 – Archi – 89121 Reggio Calabria (RC)

+39 0965 813264

Via 2 Giugno 19/10 – Bonate Sotto – 24040 (BG)

+39 035 0176860

www.goboservice.com

info@goboservice.com

